

# Land for Sale/BTS

5630 Douglas Blvd @ Quarry Ponds in Granite Bay, CA

**Price Reduction:  
\$2,500,000!**

**±2.30 ACRES**

Placer County's Only Developable Waterfront Commercial Land  
Rare Opportunity-Approved & Entitled for ±24,000 SF

**Tyler Boyd**

916.751.3625

tboyd@kiddermathews.com

LIC #01927167

**Kevin Sheehan**

916.751.3601

ksheehan@kiddermathews.com

LIC #0936093

[kiddermathews.com](http://kiddermathews.com)

**km** Kidder  
Mathews

# Land for Sale/BTS

5630 Douglas Blvd @ Quarry Ponds in Granite Bay, CA

## Sale Price: \$2,500,000

Rare Granite Bay Commercial Land for Sale

Approved Entitled Site can accommodate up to ±24,000 SF

Only Commercial Waterfront Land Available for Development on I-80 from Roseville to Lake Tahoe

Douglas Blvd Visibility & Signage Opportunity

Zoned OP-DC (Office Professional-Design Scenic Corridor)

Variety of Uses Allowed such as Office, Medical, Educational, and Assembly

Site Improvement Plans approved and all Entitlement Studies & Report Done

Adjacent to award-winning Quarry Ponds Retail & Restaurant Center where Peet's Coffee, Hawks Restaurant and many other attractive tenants are located

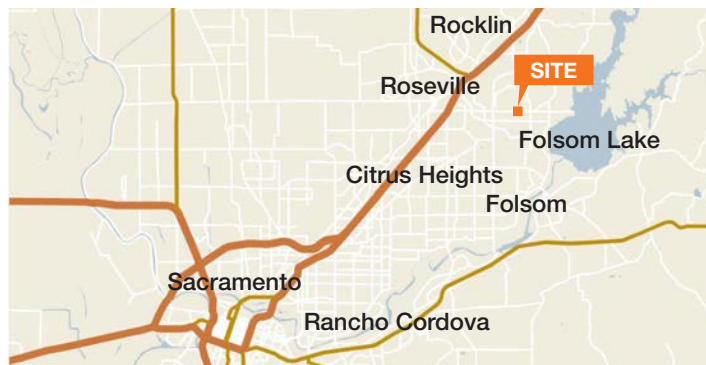

**Tyler Boyd**

916.751.3625

tboyd@kiddermathews.com

LIC #01927167

**Kevin Sheehan**

916.751.3601

ksheehan@kiddermathews.com

LIC #0936093

[kiddermathews.com](http://kiddermathews.com)

**km** Kidder  
Mathews

This information supplied herein is from sources we deem reliable. It is provided without any representation, warranty or guarantee, expressed or implied as to its accuracy. Prospective Buyer or Tenant should conduct an independent investigation and verification of all matters deemed to be material, including, but not limited to, statements of income and expenses. Consult your attorney, accountant, or other professional advisor.

# Land for Sale/BTS

5630 Douglas Blvd @ Quarry Ponds in Granite Bay, CA

## Site Plan & Renderings

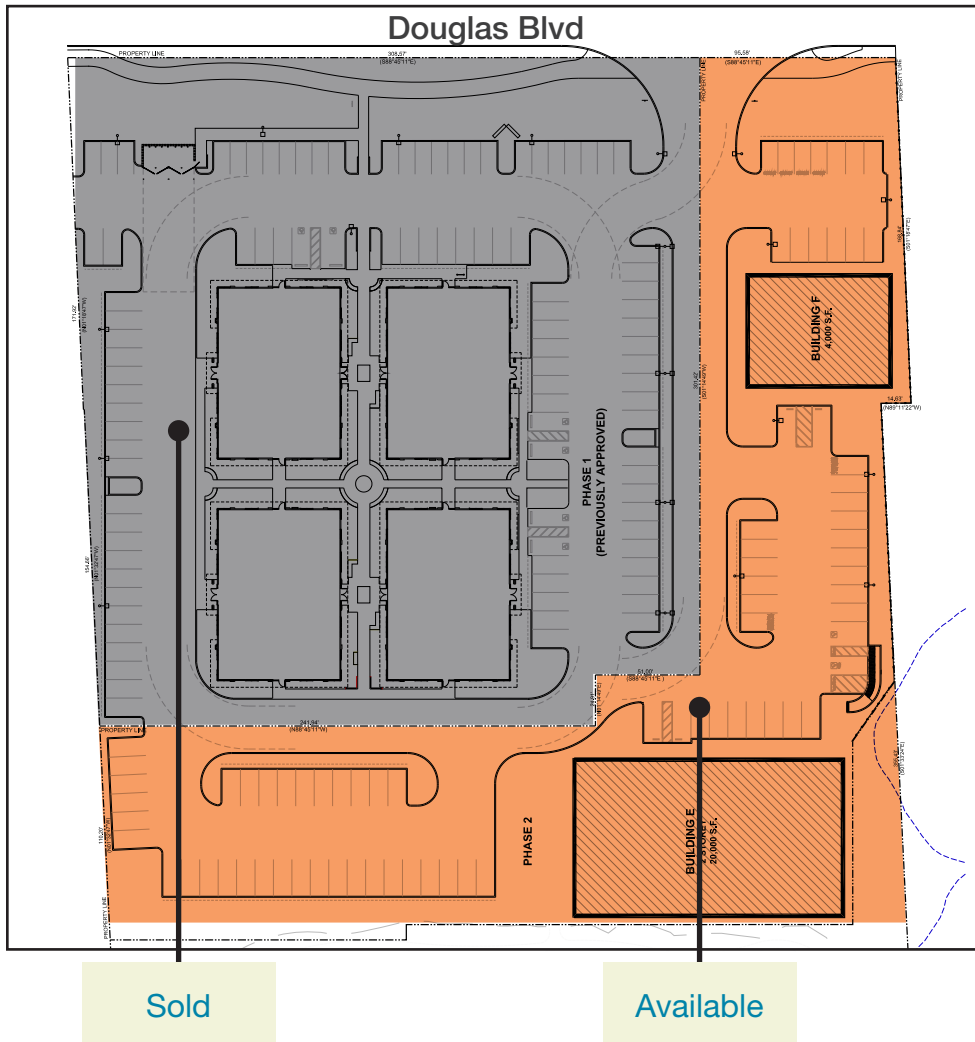

**Tyler Boyd**  
916.751.3625  
tboyd@kiddermathews.com  
LIC #01927167

**Kevin Sheehan**  
916.751.3601  
ksheehan@kiddermathews.com  
LIC #0936093

[kiddermathews.com](http://kiddermathews.com)



# Land for Sale/BTS

5630 Douglas Blvd @ Quarry Ponds in Granite Bay, CA

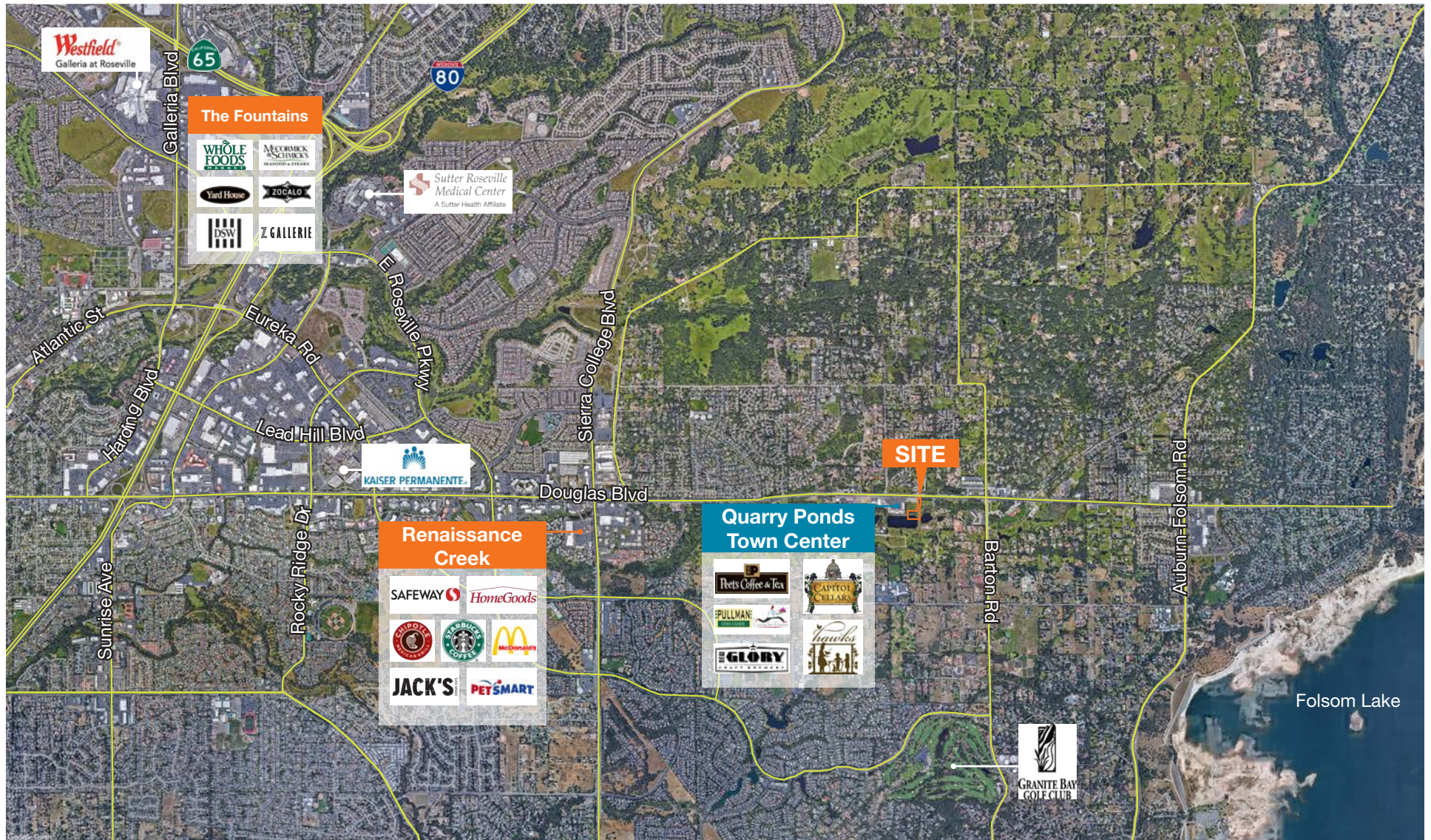

**Tyler Boyd**  
 916.751.3625  
 tboyd@kiddermathews.com  
 LIC #01927167

**Kevin Sheehan**  
 916.751.3601  
 ksheehan@kiddermathews.com  
 LIC #0936093

[kiddermathews.com](http://kiddermathews.com)



# Land for Sale/BTS

5630 Douglas Blvd @ Quarry Ponds in Granite Bay, CA



Land for Development



Pondview

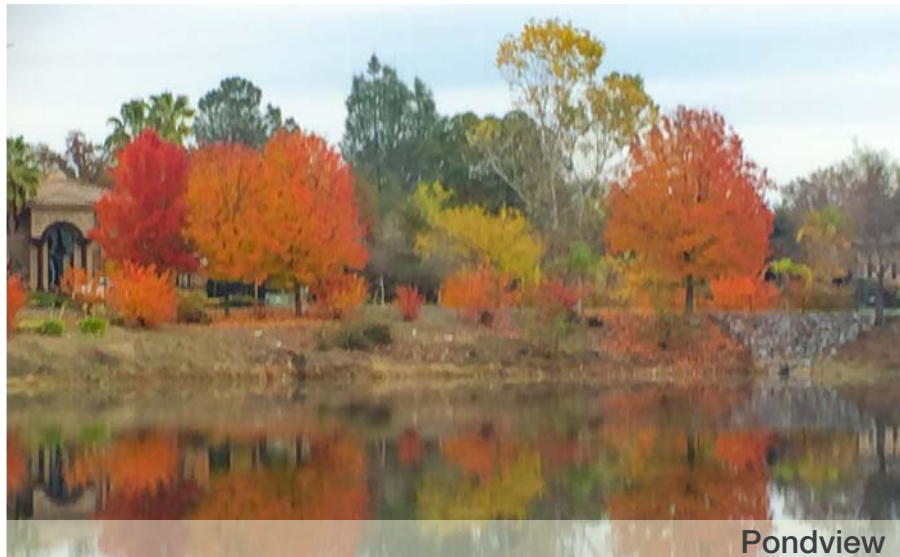

Pondview



Quarry Ponds Town Center

**Tyler Boyd**  
916.751.3625  
tboyd@kiddermathews.com  
LIC #01927167

**Kevin Sheehan**  
916.751.3601  
ksheehan@kiddermathews.com  
LIC #0936093

[kiddermathews.com](http://kiddermathews.com)

**km** Kidder  
Mathews

This information supplied herein is from sources we deem reliable. It is provided without any representation, warranty or guarantee, expressed or implied as to its accuracy. Prospective Buyer or Tenant should conduct an independent investigation and verification of all matters deemed to be material, including, but not limited to, statements of income and expenses. Consult your attorney, accountant, or other professional advisor.