

# FOR SUBLEASE

SHARED MEDICAL OFFICE SUITE AVAILABLE



## 3 CORPORATE PARK

IRVINE, CALIFORNIA 92606

## PROPERTY FEATURES

- SUITE 165: SHARED MEDICAL OFFICE SUITE
- BRAND NEW TURNKEY MEDICAL OFFICE SUITE
- A PORTION OF A PROFESSIONAL MEDICAL OFFICE SUITE
- ACCESS TO PRIVATE OFFICE, OPEN AREA AND RECEPTION AREA
- EXCELLENT ACCESS TO THE 5, 405 AND 55 FREEWAYS
- LOCATED IN THE PRESTIGIOUS CITY OF IRVINE
- CLOSE PROXIMITY TO RESTAURANTS AND SHOPPING AMENITIES
- LEASE RATE: \$1,500 PER MONTH



**ERIC DARNELL**

Senior Vice President  
Lic. #01888743  
949.460.3681  
edarnell@leeirvine.com



**ERIC PARKHURST**

Associate  
Lic. #02070771  
949.790.3183  
eparkhurst@leeirvine.com



# 3 CORPORATE PARK

IRVINE, CALIFORNIA 92606





# 3 CORPORATE PARK

IRVINE, CALIFORNIA 92606

## FLOOR PLAN

### SUITE 165: SHARED MEDICAL OFFICE SPACE

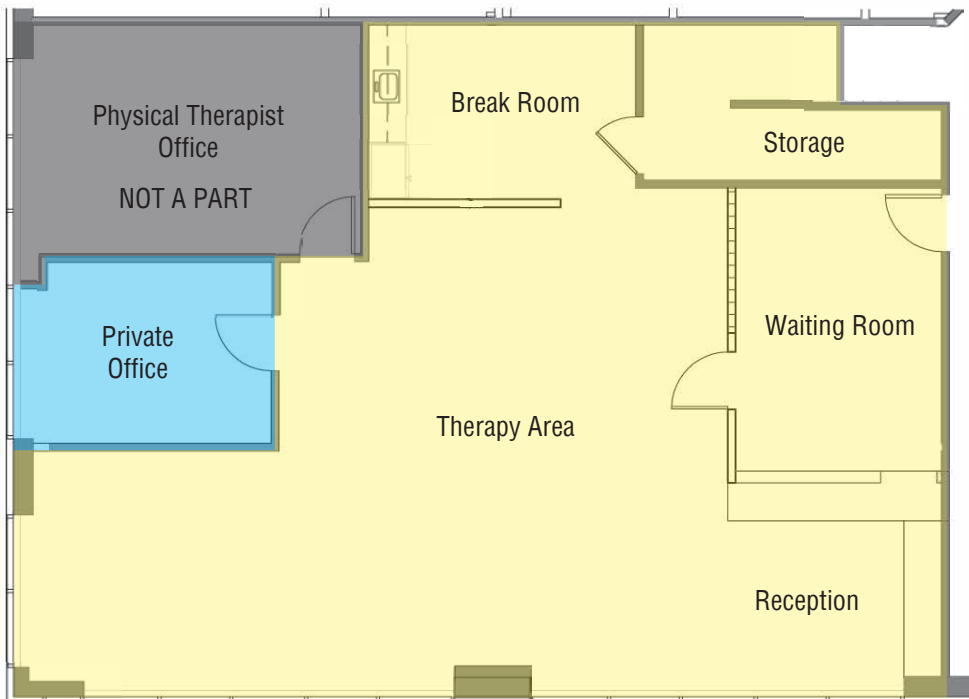

Shared

Exclusive Use



**ERIC DARNELL**  
Senior Vice President  
Lic. #01888743  
949.460.3681  
edarnell@leeirvine.com



**ERIC PARKHURST**  
Associate  
Lic. #02070771  
949.790.3183  
eparkhurst@leeirvine.com



**orange county**  
OFFICE | GROUP

