

INDUSTRIAL FOR LEASE

ANAHEIM INDUSTRIAL

923 E. Arlee Place, Anaheim, CA 92805



OFFERING SUMMARY

| | |
|-----------------------|----------------------|
| AVAILABLE SF: | 5,000 SF |
| LEASE RATE: | \$1.15 SF/month (IG) |
| LOT SIZE: | 21,344 SF |
| BUILDING SIZE: | 5,000 SF |
| ZONING: | Industrial |

PROPERTY OVERVIEW

Tom Gonzalez G&S Group | KW Commercial, presents an industrial warehouse, sublease opportunity, situated in the City of Anaheim. The warehouse is comprised of +/-5,000 SF leasable space with a 10x10 roll-up door, up to 3 offices, 1.5 restrooms, over 200 amps and a carport for customer parking. Call us for an appointment.

PROPERTY HIGHLIGHTS

- Industrial Area
- Property is Fenced
- 600 SF of office
- 1.5 Baths



KW COMMERCIAL

TOM GONZALEZ
Director
O: 714.441.8721
C: 714.726.3007
tomgonzalez.re@gmail.com
CA DRE# #01487226

We obtained the information above from sources we believe to be reliable. However, we have not verified its accuracy and make no guarantee, warranty or representation about it. It is submitted subject to the possibility of errors, omissions, change of price, rental or other conditions, prior sale, lease or financing, or withdrawal without notice. We include projections, opinions, assumptions or estimates for example only, and they may not represent current or future performance of the property. You and your tax and legal advisors should conduct your own investigation of the property and transaction.

Each Office Independently Owned and Operated kwcommercial.com

ANAHEIM INDUSTRIAL WAREHOUSE

Sublease

923 East Arlee Place, Anaheim California 92805

Building +/- 5,000 SF

Floor Plan

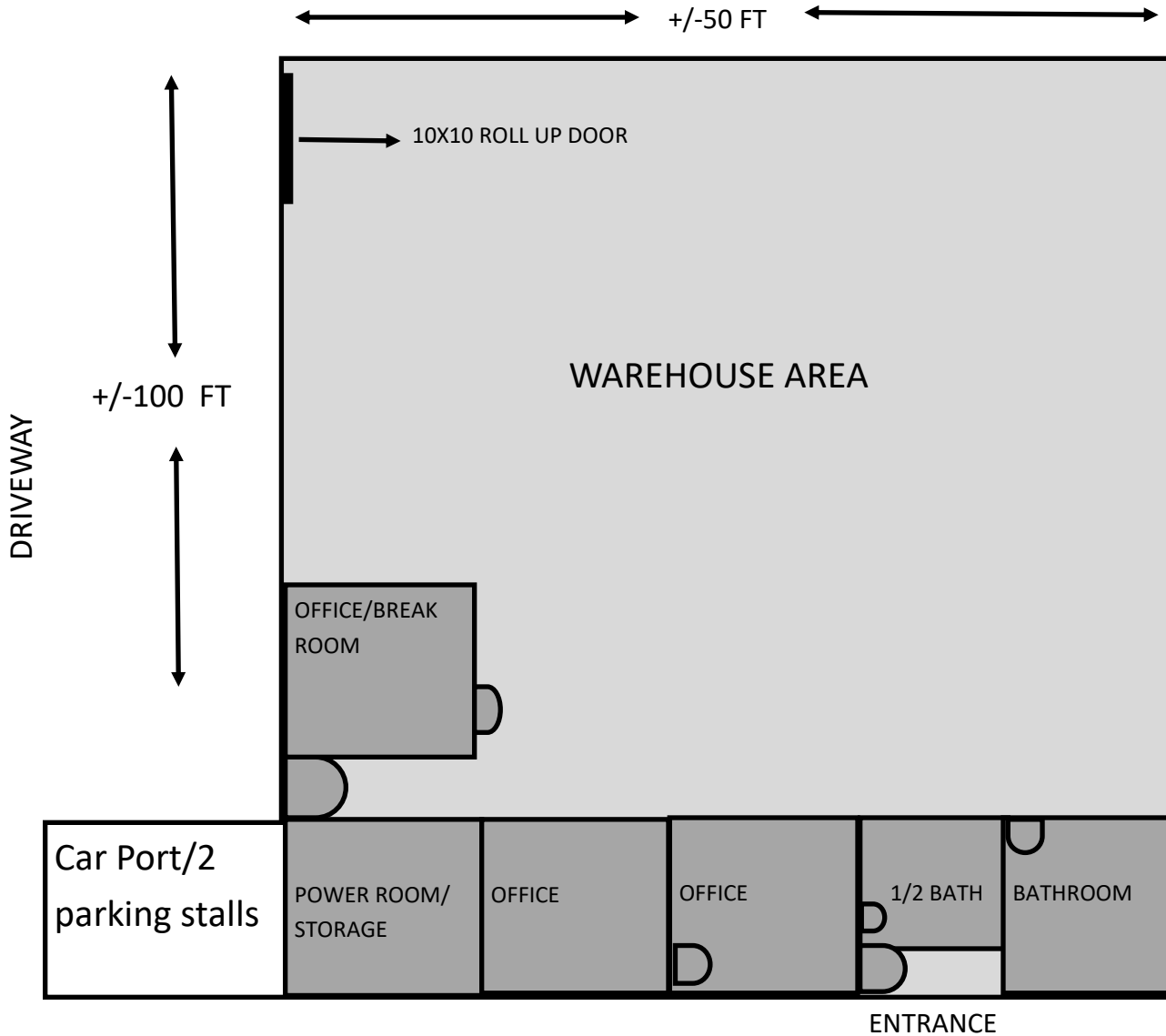

For more information call

Tom Gonzalez, Director 714.726.3007



G & S GROUP
COMMERCIAL REAL ESTATE SERVICES



180 N. Riverview Drive Suite 320,

Anaheim Hills California 92808

ANAHEIM | BREA | FULLERTON | LAGUNA NIGUEL