



**FOR SALE  
OR LEASE**

# Tierney Electric

7901 SEVENTH AVENUE SOUTH, SEATTLE, WA



## PRICE REDUCTION

### Excellent South Park location

**17,450** gross square feet

**MEZZANINE** office includes 1,350 SF

**LOADING** doors include 1 grade-level and 2 dock-high

**SALE** price \$3,525,000

**MONTHLY** NNN lease rate of \$0.75 PSF or \$13,087.50

**14'** foot clear height

**ONE** column row

**AVAILABLE** now

**CHRIS CORR**  
206.248.7324  
[chris.corr@kidder.com](mailto:chris.corr@kidder.com)

**JIM KIDDER, SIOR**  
206.248.7328  
[jim.kidder@kidder.com](mailto:jim.kidder@kidder.com)

[KIDDER.COM](http://KIDDER.COM)

**\$3.525M**

**SALE PRICE**

**NOW**

**AVAILABLE DATE**

**14'**

**CLEAR HEIGHT**

This information supplied herein is from sources we deem reliable. It is provided without any representation, warranty, or guarantee, expressed or implied as to its accuracy. Prospective Buyer or Tenant should conduct an independent investigation and verification of all matters deemed to be material, including, but not limited to, statements of income and expenses. Consult your attorney, accountant, or other professional advisor.

**Kidder  
Mathews**

FOR SALE / LEASE

# Tierney Electric

7901 SEVENTH AVENUE SOUTH, SEATTLE, WA

**NOW**

DATE AVAILABLE

**17,450**

SQUARE FEET

**1,350**

MEZZANINE OFFICE  
SQUARE FEET

## Floor Plan

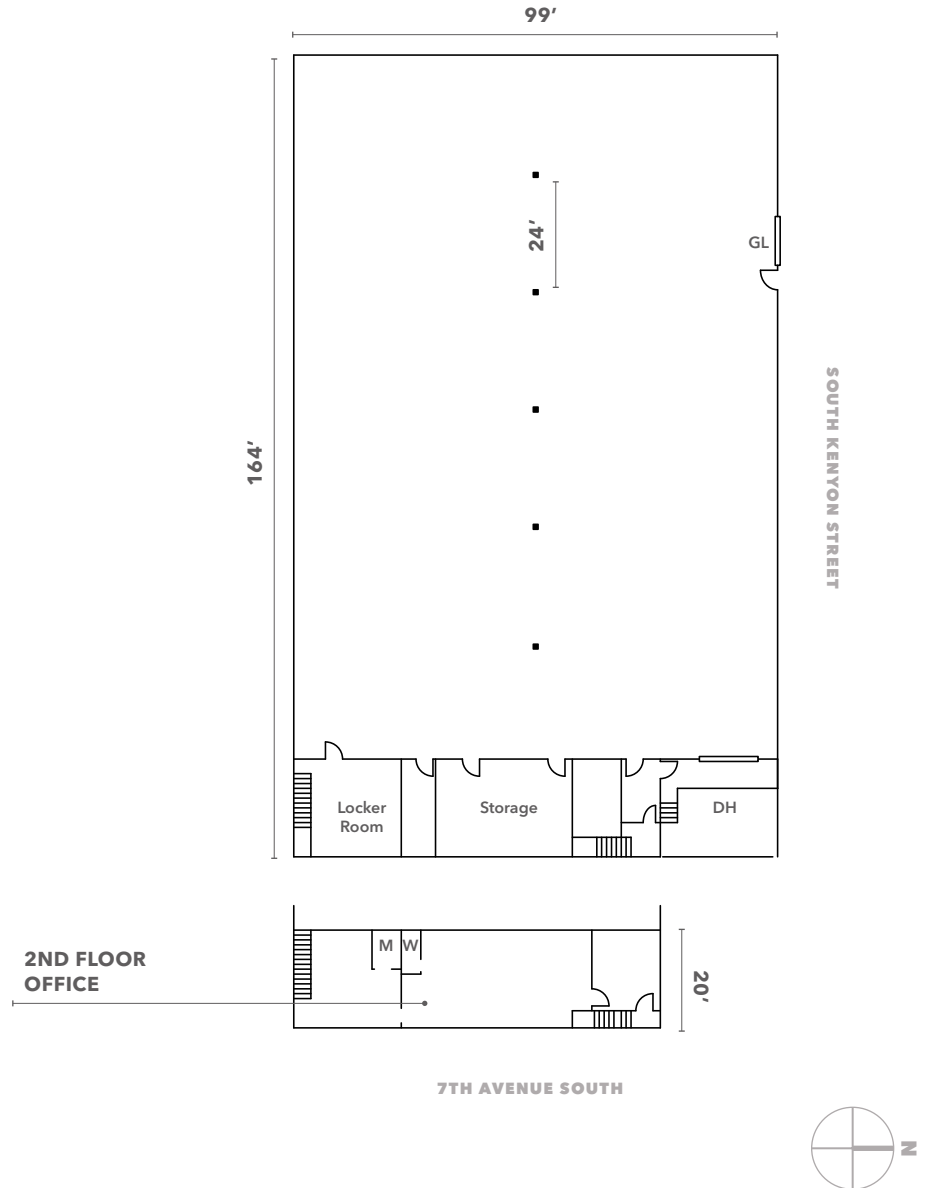

**CHRIS CORR**  
206.248.7324  
chris.corr@kidder.com

**JIM KIDDER, SIOR**  
206.248.7328  
jim.kidder@kidder.com

[KIDDER.COM](http://KIDDER.COM)

**km Kidder Mathews**

This information supplied herein is from sources we deem reliable. It is provided without any representation, warranty, or guarantee, expressed or implied as to its accuracy. Prospective Buyer or Tenant should conduct an independent investigation and verification of all matters deemed to be material, including, but not limited to, statements of income and expenses. Consult your attorney, accountant, or other professional advisor.