



# Kent 228 - Building D

22643 83RD AVENUE SOUTH, SUITE E-F, KENT, WA

## FOR LEASE



±13,500  
square feet  
total with  
2,500 square  
feet of office  
available for  
lease in Kent



**CHRISTOPHER J. CORR**  
206.248.7324  
[chris.corr@kidder.com](mailto:chris.corr@kidder.com)

**FOR LEASE**

# Kent 228 - Building D

22643 83RD AVENUE SOUTH, SUITE E-F, KENT, WA

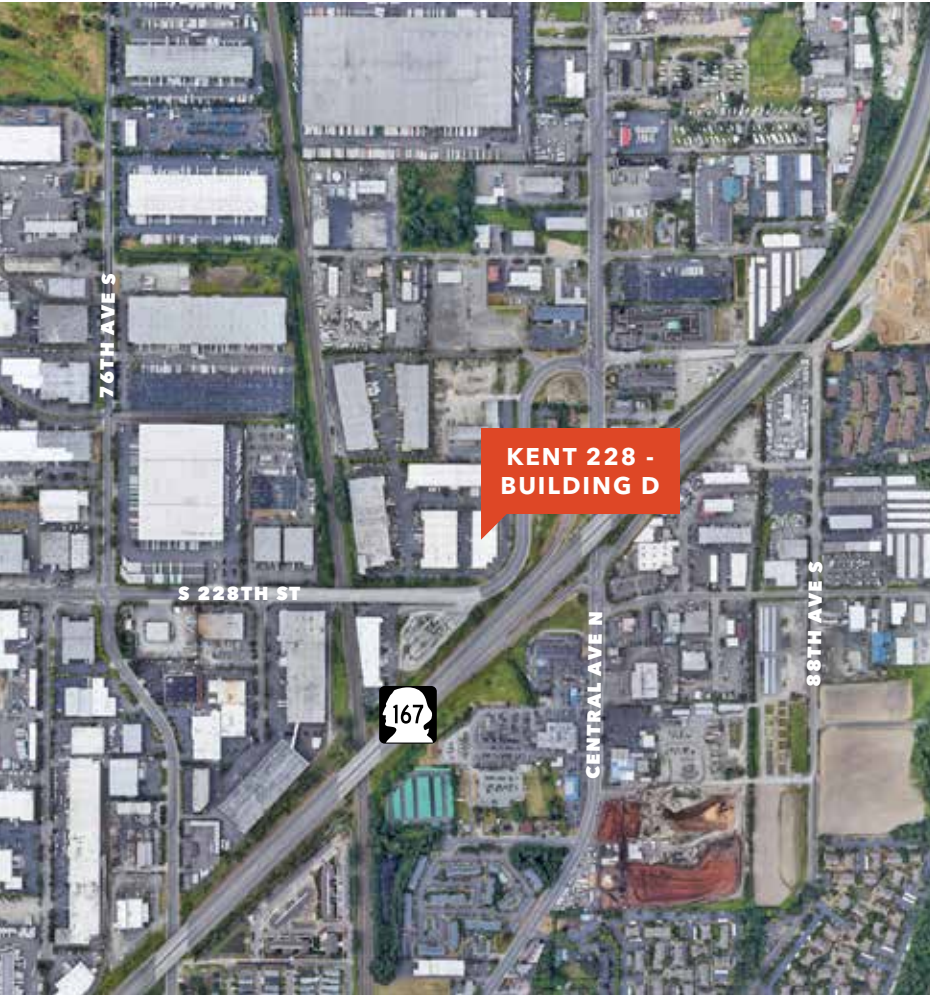

**Fantastic  
exposure and  
visibility**

±13,500 square feet total

2,500 square feet office

24' clear height

Close to SR-167 for  
excellent access

Well maintained park

4 grade-level loading door

M-3 zoning

Call agent for rates

Available now

**CHRISTOPHER J. CORR**

206.248.7324

chris.corr@kidder.com

**KIDDER.COM**

This information supplied herein is from sources we deem reliable. It is provided without any representation, warranty, or guarantee, expressed or implied as to its accuracy. Prospective Buyer or Tenant should conduct an independent investigation and verification of all matters deemed to be material, including, but not limited to, statements of income and expenses. Consult your attorney, accountant, or other professional advisor.

**km** Kidder  
Mathews

FOR LEASE

# Kent 228 - Building D

22643 83RD AVENUE SOUTH, SUITE E-F, KENT, WA

## Floor Plan

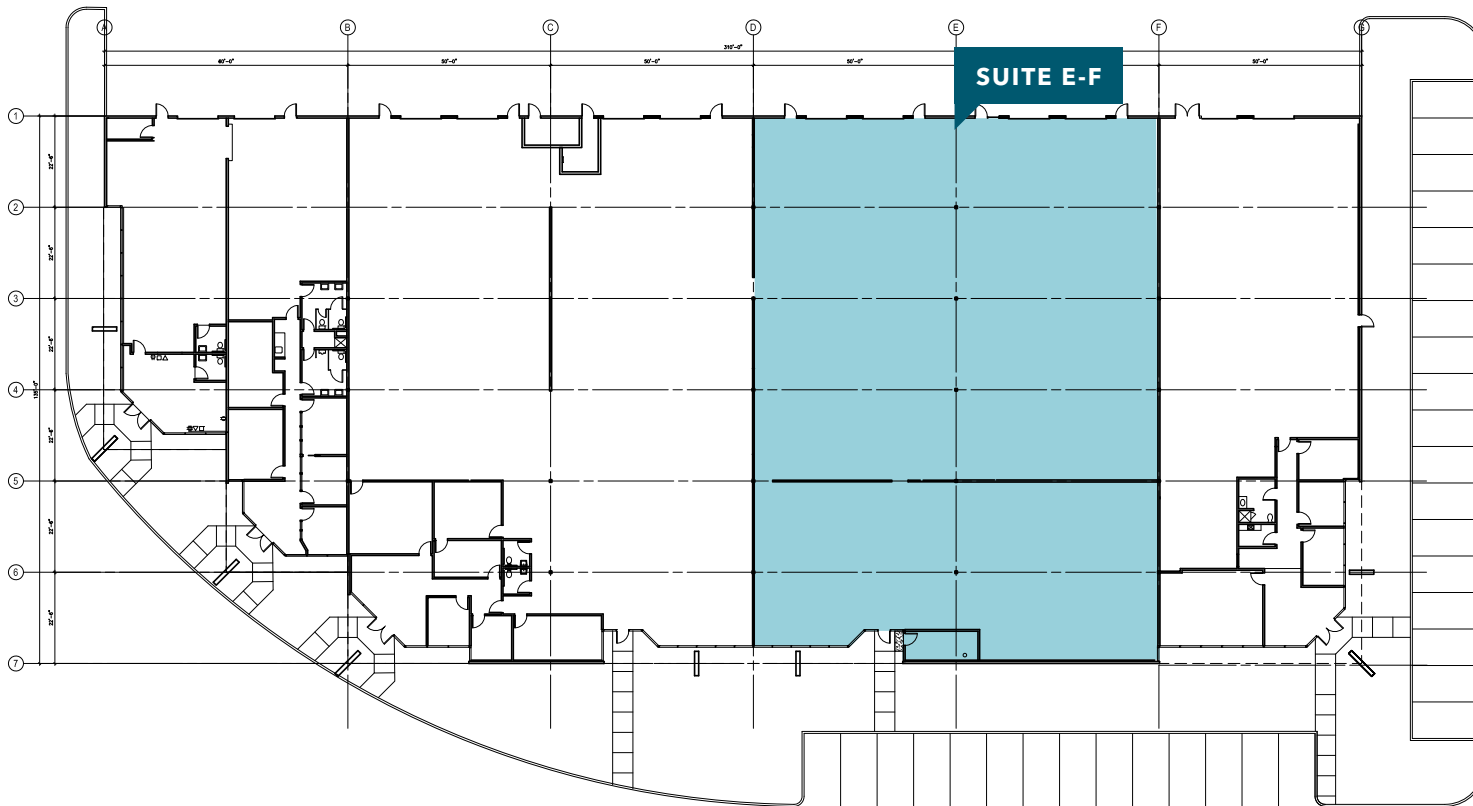

KIDDER.COM

This information supplied herein is from sources we deem reliable. It is provided without any representation, warranty, or guarantee, expressed or implied as to its accuracy. Prospective Buyer or Tenant should conduct an independent investigation and verification of all matters deemed to be material, including, but not limited to, statements of income and expenses. Consult your attorney, accountant, or other professional advisor.

**NOW**

DATE AVAILABLE

**±13,500**

SQUARE FEET TOTAL

**2,500**

SQUARE FEET OFFICE

**CHRISTOPHER J. CORR**

206.248.7324

[chris.corr@kidder.com](mailto:chris.corr@kidder.com)

**km** Kidder  
Mathews

FOR LEASE

# Kent 228 - Building D

22643 83RD AVENUE SOUTH, SUITE E-F, KENT, WA

## Site Plan



24'

CLEAR HEIGHT

4 GL

LOADING DOORS

M-3

ZONING

CHRISTOPHER J. CORR

206.248.7324

[chris.corr@kidder.com](mailto:chris.corr@kidder.com)



KIDDER.COM

This information supplied herein is from sources we deem reliable. It is provided without any representation, warranty, or guarantee, expressed or implied as to its accuracy. Prospective Buyer or Tenant should conduct an independent investigation and verification of all matters deemed to be material, including, but not limited to, statements of income and expenses. Consult your attorney, accountant, or other professional advisor.

**km** Kidder  
Mathews