

FOR SALE



5 MUSICK

IRVINE SPECTRUM, 92618

±7,404 SF INDUSTRIAL/TECHNOLOGY FACILITY

PROPERTY HIGHLIGHTS

- Freestanding single-story building
- ±3,700 square foot office/technology area
- Prominent frontage on Irvine Blvd.
- 1 ground loading door
- Corner building
- Prestigious Irvine Spectrum address
- 3:1,000 parking
- Easy access to Santa Ana (I-5), San Diego (405), Foothill (241), and Laguna (133) freeways
- 20 minutes to John Wayne Airport
- Dining and shopping located within walking distance at Tripointe Spectrum Center

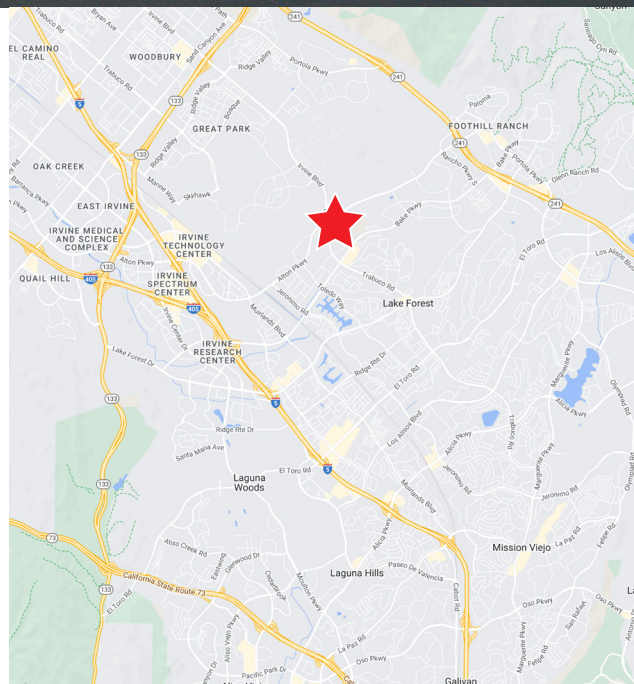

LEE & ASSOCIATES
COMMERCIAL REAL ESTATE SERVICES

ORANGE COUNTY
COMMERCIAL REAL ESTATE GROUP

GUY LAFERRARA
Senior Vice President
CalDRE 01012355
949.790.3115
glaferrara@leeirvine.com

BROCK STRYKER
Vice President
CalDRE 01928271
949.790.3131
bstryker@leeirvine.com

TRAVIS BARNETT
Associate
CalDRE 02069500
949.790.3145
tbarnett@leeirvine.com

5 MUSICK, IRVINE, CA 92618

FAIRBANKS BUSINESS PARK



FLOOR PLAN

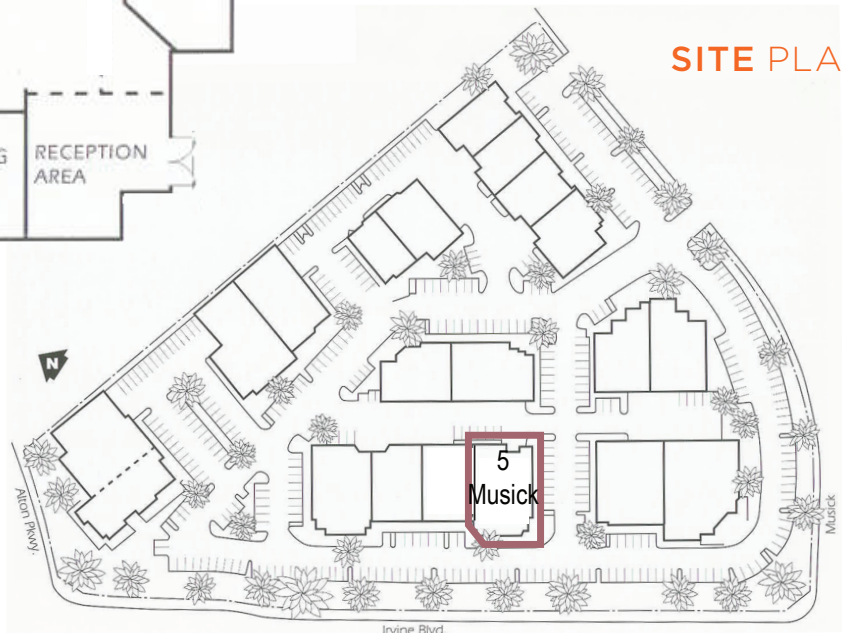

SITE PLAN